

wiper A27-SD

seal spec

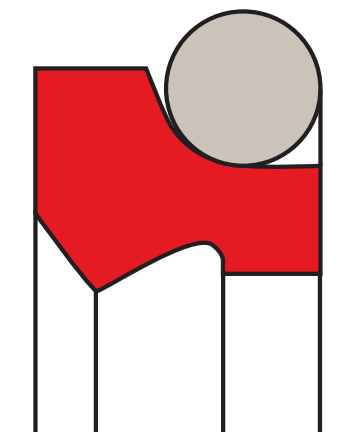

description

wiper A27-SD is a patented double-acting scraper. it has an identical design and function as that of the A27-SB & A27-SC and is fully interchangeable with this scraper. it is more flexible and thus easy to install, but cannot withstand such high speeds and temperatures as the A27-SB & A27-SC. the A27-SD is injection moulded from high-grade wear-resistant polyurethane. it is suitable as an inexpensive scraper element where large quantities are required. it is preferably used in conjunction with our rod seal S09-E with hydrodynamic back-pumping function.

application



not bolded symbols; please consult our technical for application limitations

category of profile

machined or molded/standard/trade product.

double acting

advantages:

- high abrasion resistance, suitable for heavy-duty applications.
- good scraping effect both internal and external.
- high flexibility.
- compensates radial deflections of the piston rod.
- identical in installation with A27-SB & A27-SC.
- low cost, economical solution.
- ISO/DIN 6195 Type D installation dimensions.

media

mineral oil-based hydraulic fluids.

function:

A27 wipers are designed to keep dust, dirt, sand and metal chips from the sealing and guiding elements, thereby avoiding abrasive damage caused by external contamination.

operating parameters & material

material		temperature	max. surface speed
sealing element	energizer		
s-mart PU	s-mart NBR (70 shore A)	-30 °C ... +80 °C	1 m/s

the stated operation conditions represent general indications. it is recommended not to use all maximum values simultaneously. surface speed limits apply only to the presence of adequate lubrication film.

fitting & installation

A27-SD can be installed in split and closed grooves. installation in closed grooves is possible above a rod diameter of 25 mm. for smaller diameters, a split groove is recommended.

**surface quality**

surface roughness	Rtmax (µm)	Ra (µm)		
sliding surface	according to seal data			
bottom of groove	≤6,3	≤1,6		
groove face	≤15	≤3		
Ød	≤10	>10 ... ≤63	>63 ... ≤250	>250
R max	0,4	0,7	1	1,5

tolerance recommendation**seal housing tolerances**

L	+0,2
ØD	H9

seal & housing recommendations

please note that we are able to produce those profiles to your specific need or any non standard housing. for detail measurements, please see seal-mart catalog...

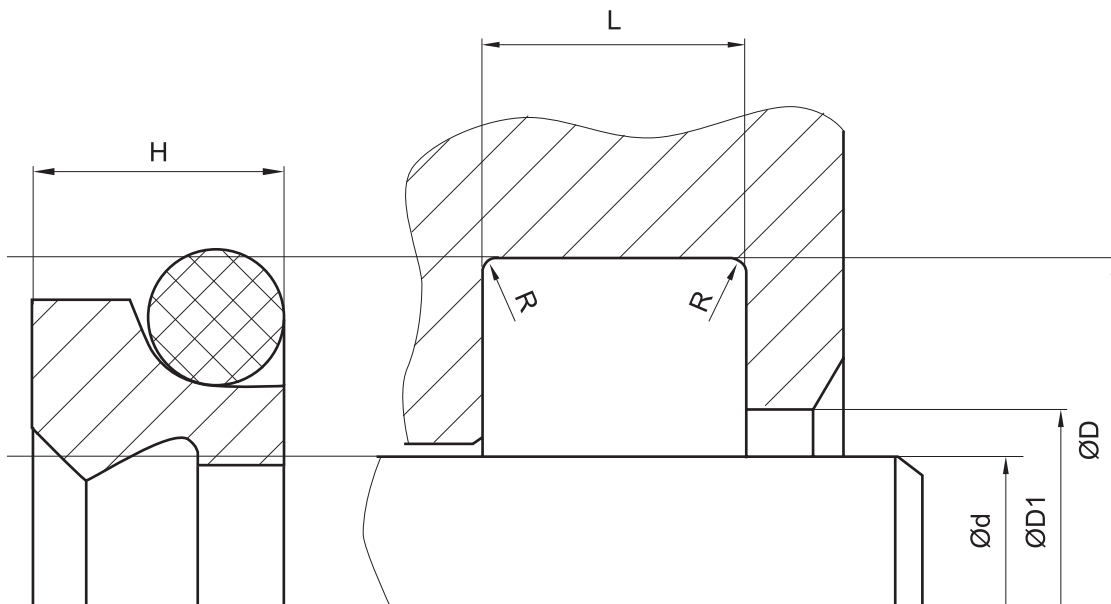

don't hesitate to contact our technical department for further information or for special requirements (temperature, speed etc.), so that suitable materials and/or designs can be recommended.